

SE Cor. Sec. 13, T32, R23

Reset Red and White Iron Pipe in revised position by resurvey.
(22.47' No. on Sec. line)

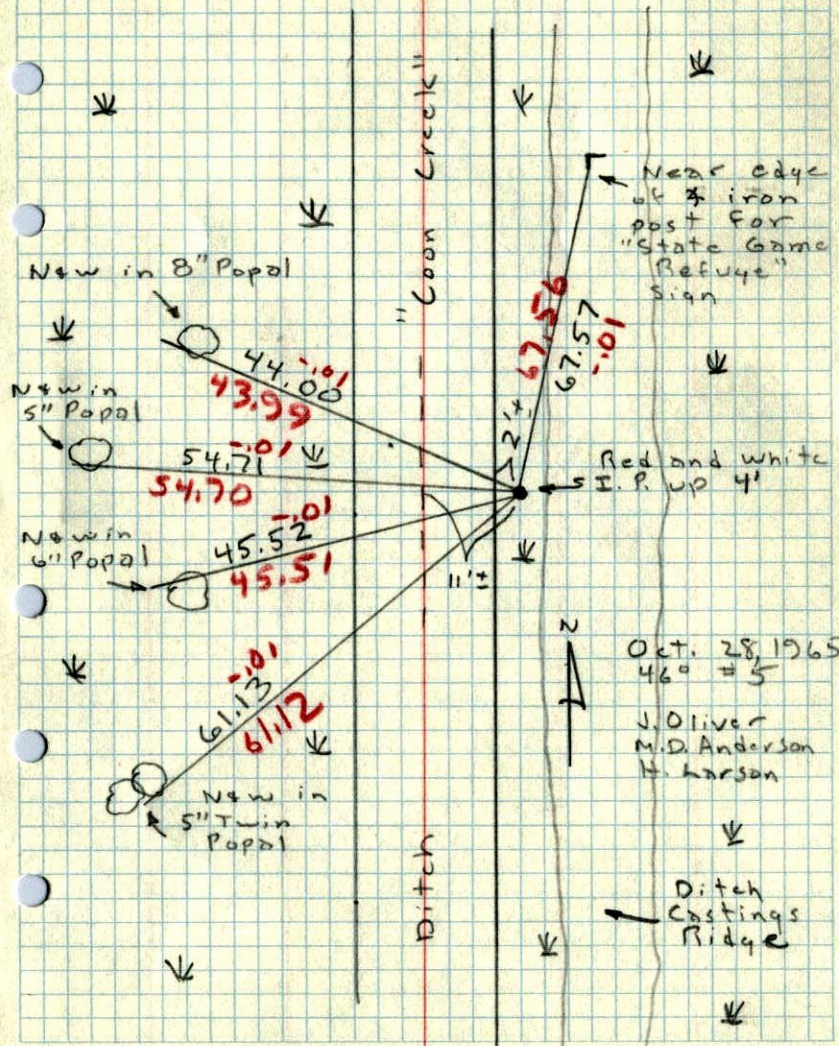

SE

13

47

NE Cor. Sec. 24, T32, R23

Found 3"-5' long Popal Post with Top 2' Squared off and "SEC COR" written with Blue Crayon (slightly legible) - replaced with 8 1/2' long 1" I.P. with 6" Spaced Red and white markings - Top is up 4' -

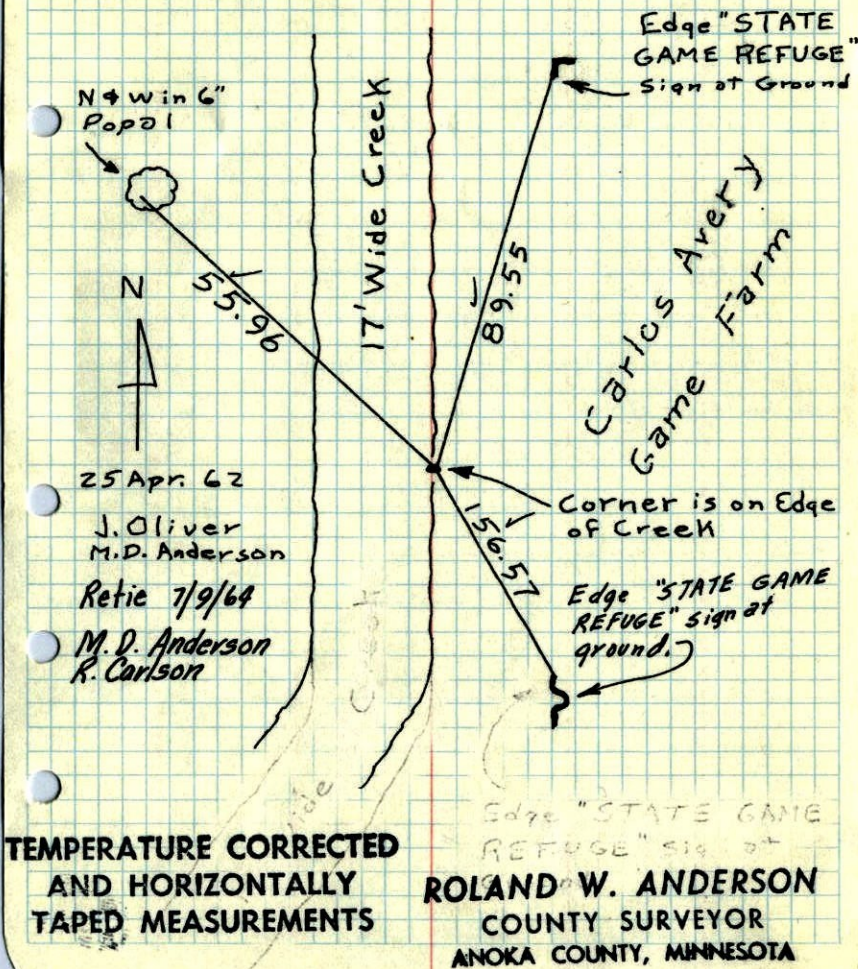

TEMPERATURE CORRECTED
AND HORIZONTALLY
TAPED MEASUREMENTS

ROLAND W. ANDERSON
COUNTY SURVEYOR
ANOKA COUNTY, MINNESOTA